



Coming in from the cold

After a year in a mobile home, Samantha Taylor was finally able to return to her renovated home with its fabulous new kitchen



◀ Samantha opted for an unobtrusive Kohler one-and-a-half-bowl stainless-steel sink and teamed it with a Perrin & Rowe Phoenician mixer tap. The overall effect along with the honed Indian black granite is one of classic simplicity and practicality. The sink area also affords Samantha a wonderful view of her garden, her love of which hasn't diminished even though she lived in it in a mobile home during the renovations



◀ As Samantha has always had Agas and found them great to work with, she didn't want to go for anything different in her new kitchen, but she added a small two-ring gas hob to the island unit to give her extra versatility with her cooking. The Neff domino hob, with one standard and one high-speed burner, is made of black ceramic glass trimmed with stainless steel, which curves at the front following the shape of the cast-iron pan support

When Samantha Taylor rebuilt and extended a substantial part of her five-bedroom Georgian home, the work was so protracted that she spent a year living in a mobile home in the garden while it was being carried out. However, this turned out to be an advantage as it gave her plenty of time to think about how she wanted her new kitchen to look. 'I extended the back of the house,' says Samantha, 'to create a spacious kitchen and a utility room. While it is much bigger, the new kitchen is similar in its layout to the old one, which also had an island. In addition, I told the designer that it had to be able to incorporate the old kitchen dining table and chairs.'

Samantha settled on designer Bill Davies at Penny's Mill because he had been recommended to her by a friend. 'I want to see examples of his work,' says Samantha, 'and I liked what I saw.'

Opting for simple painted and natural timber cabinets, selecting ash because of its interesting grain, Samantha was keen to have granite worksurfaces, rather than wood. 'I really like the look of granite and I wanted something different to what I'd had before,' she explains. 'I liked the idea of a lot of drawers to hold saucepans, because it's so much easier finding a pan in a drawer than it is in cupboard. I also asked for integrated fridges surrounded by larder cupboards to keep all the food in one place.'

Samantha has grown-up children who are always popping in and she does a lot of entertaining with friends, too, so she asked Bill to incorporate two dishwashers into the design. 'Basically, it's because I don't like washing up,' she smiles.

The new kitchen is a big hit with Samantha. 'It is such a lovely, welcoming room, that when people visit, we just spend all our time in here,' says Samantha 'It's become the centre of the house and was well worth a year in a mobile home.'



◀ The Aga surround is painted in the same colour as the island, while the splashback tiles are Argille Bianco from CTD Newbury. The hotplate on the far left of the Aga is the boiling plate, which can boil water faster than most electric kettles. The two on the right are for simmering and griddling, and both can heat three saucepans at once. Of the four ovens, one is designed specifically for roasting, one for baking, one for simmering and one for warming



Don't be constrained by design. I wanted the room to be quite symmetrical, and on paper it was, but when the island was built it looked better nearer to the Aga, so we moved it

The walls are painted in a specially mixed colour from Paper & Paints' traditional range, while the ceiling is Cameo White by Sanderson. The blind was made using Zarafshan fabric from Lewis and Wood



THE KITCHEN FILE

DESIGN & CABINERY

- Bill Davies at Penny's Mill, Nunney, Frome, Somerset BA11 4NP (01373 836210) www.pennysmill.com
- Bespoke English ash and painted cabinetry

WORKTOPS

- Honed Indian black granite. Approx price per sq m **£477**

SINK AND TAP

- Icerock 3352 undermounted one-and-a-half-bowl sink in stainless steel, Kohler **£540**
- Phoenician 4460 lever mixer tap, Perrin & Rowe **£176**

APPLIANCES (shown)

- Four-oven Aga in pewter, from **£7,275**
- N2262N3 two-ring gas hob, Neff **£400**
- H5430NOGB microwave, Neff **£505**

APPLIANCES (not shown)

- Integrated larder fridge, Miele **£752**
- Integrated larder fridge, Miele **£694**
- 2 x Integrated dishwashers, Miele, each **£790**

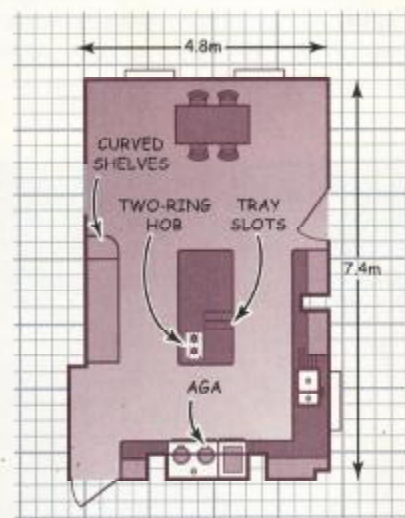

GUIDE PRICE

- Total cost **£36,000**

Where to buy Aga 0845 712 5207 Artisans of Devides 01380 720007 CTD Newbury 01635 521197 Farrow & Ball 01202 876141 Kohler 0870 850 5561 Lewis and Wood 01453 860080 Miele 0845 330 3666 Neff 0870 513 3090 Paper & Paints 020 7352 8626 Perrin & Rowe 01708 526361 Sanderson 0161 230 0881



The units are made from a mixture of solid and veneer English ash and the unit handles are made from birch with a tinted lacquer spray. The island unit was painted on site in Castle Grey by Farrow & Ball. For similar flooring try Rodes Limestone in a vintaged finish from Artisans of Devizes. 'I also opted for underfloor heating, which everyone loves,' smiles Samantha, 'especially my two dogs Kaya and Smartie - it's definitely a hit with them'